

FRONT TERMINAL BATTERY FT12-80(12V80AH/10HR)

Specifications

| | | |
|----------------------------------|--|------------------------------|
| Nominal Voltage | 12V | |
| Nominal Capacity(10hr) | 80AH | |
| Dimension | Length | 562±2mm(22.13inch) |
| | Width | 115±2mm(4.53inch) |
| | Height | 187±2mm(7.36inch) |
| | Total Height | 194±2mm(7.64inch) |
| Approx Weight | Approx. 25kg(±4%) | |
| Terminal Type | M6 | |
| container Material | ABS(UL-94HB) | |
| Internal Resistance | Approx.6mΩ | |
| Rated Capacity | 84.0AH | (20hr, 1.70V/cell,25°C/77°F) |
| | 80.0AH | (10hr, 1.75V/cell,25°C/77°F) |
| | 68.0.0AH | (5hr, 1.75V/cell,25°C/77°F) |
| | 60.0AH | (3hr, 1.70V/cell,25°C/77°F) |
| | 44..0AH | (1hr, 1.60V/cell,25°C/77°F) |
| Max. Discharge Current | 900A(5S) | |
| Nominal Operating Temp. Range | 25±3°C (77±5°F) | |
| Cycle Use | Charge Current Less Than 0.25CA | |
| | 14.1V~14.7V@25°C(77°F)Temp. Coefficient -30mV/°C | |
| Floating Use | No limit on Initial Charging Current Voltage | |
| | 13.5V~13.8V@25°C(77°F)Temp. Coefficient -20mV/°C | |
| Capacity affected by Temperature | 40°C | 103% |
| | 25°C | 100% |
| | 0°C | 86% |
| | -15°C | 65% |
| Self-discharge | 3 month | Remaining capacity: 91% |
| | 6 month | Remaining capacity:82% |
| | 12month | Remaining capacity:65% |



Dimensions

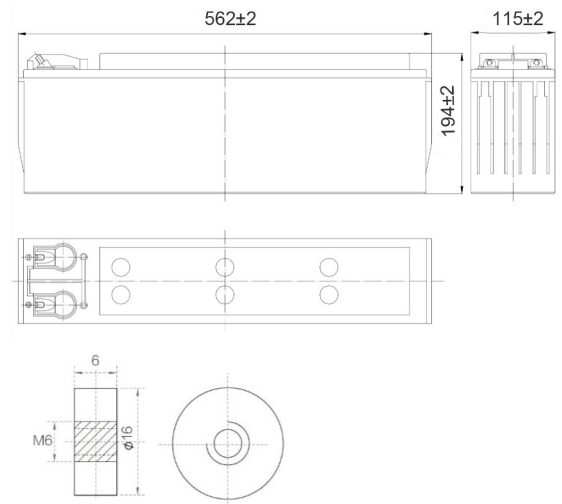

Terminal M6

Constant Power Discharge at 25°C(77°F)

| F.V/Time | 5min | 10min | 15min | 30min | 1h | 2h | 3h | 4h | 5h | 6h | 10h | 20h |
|------------|------|-------|-------|-------|------|------|------|------|------|------|------|------|
| 1.80V/cell | 295 | 250 | 196 | 144 | 83,3 | 50,7 | 35,4 | 27,0 | 22,0 | 19,2 | 14,4 | 8,30 |
| 1.75V/cell | 308 | 251 | 214 | 148 | 84,5 | 51,9 | 36,1 | 27,3 | 22,6 | 19,6 | 15,5 | 8,42 |
| 1.70V/cell | 322 | 270 | 230 | 152 | 87,0 | 53,0 | 36,8 | 28,2 | 23,1 | 19,8 | 15,9 | 8,42 |
| 1.67V/cell | 343 | 277 | 235 | 154 | 89,4 | 53,6 | 37,5 | 28,7 | 23,7 | 20,1 | 16,2 | 8,42 |
| 1.60V/cell | 350 | 281 | 237 | 155 | 91,5 | 54,7 | 37,7 | 29,3 | 24,2 | 20,2 | 16,3 | 8,42 |

Constant Current Discharge at 25°C(77°F)

| F.V/Time | 5min | 10min | 15min | 30min | 1h | 2h | 3h | 4h | 5h | 6h | 10h | 20h |
|------------|------|-------|-------|-------|------|------|------|------|------|------|------|------|
| 1.80V/cell | 176 | 132 | 106 | 77 | 43,7 | 27,4 | 20,4 | 15,6 | 13,0 | 11,6 | 7,88 | 4,10 |
| 1.75V/cell | 196 | 152 | 112 | 78 | 45,4 | 28,1 | 20,6 | 15,7 | 13,2 | 11,6 | 7,94 | 4,17 |
| 1.70V/cell | 201 | 155 | 120 | 80 | 46,2 | 28,8 | 20,9 | 15,8 | 13,5 | 11,8 | 7,99 | 4,19 |
| 1.67V/cell | 211 | 157 | 122 | 81 | 47,1 | 29,5 | 21,0 | 15,8 | 13,7 | 11,9 | 8,10 | 4,20 |
| 1.60V/cell | 213 | 158 | 124 | 82 | 47,8 | 30,2 | 21,2 | 16,0 | 13,8 | 12,0 | 8,21 | 4,21 |

FRONT TERMINAL BATTERY FT12-80(12V80AH/10HR)

Discharge Characteristics

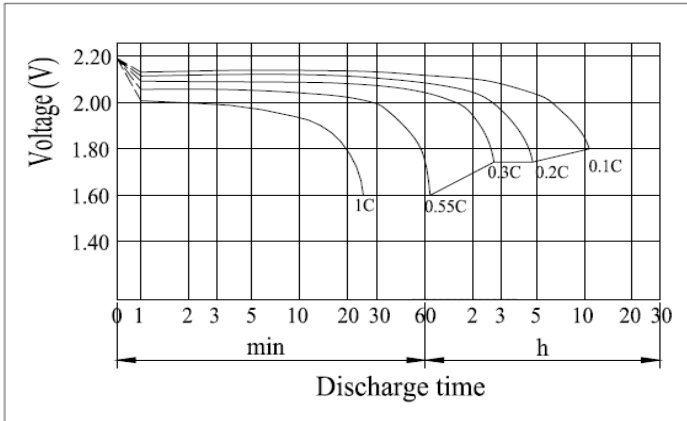

Float Charging Characteristics

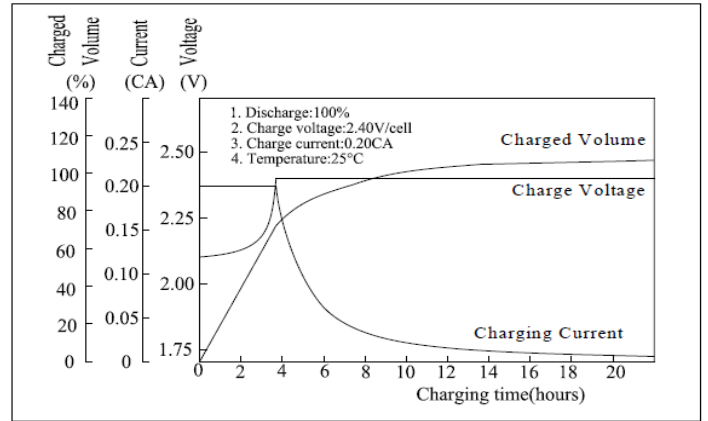

Floating Life on Temperature

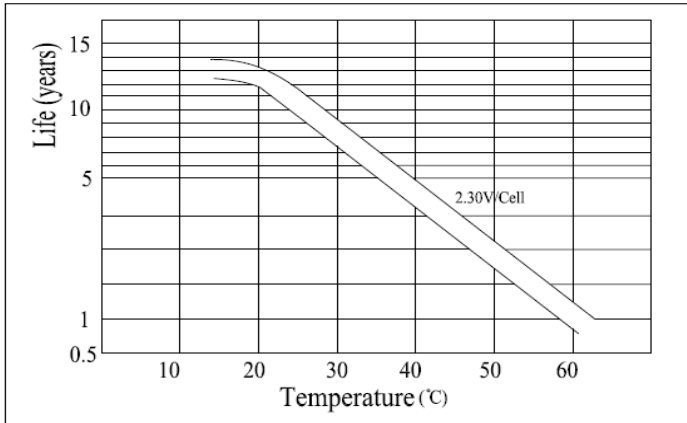

Self Discharge Characteristics (25°C(77°F))

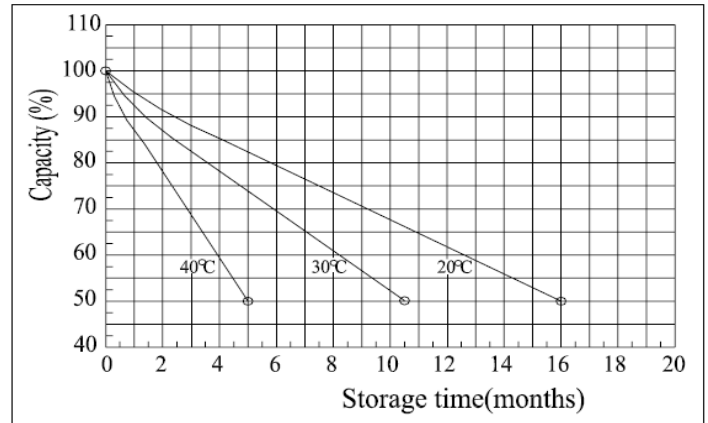

Temperature Effects in Relation to Battery Capacity

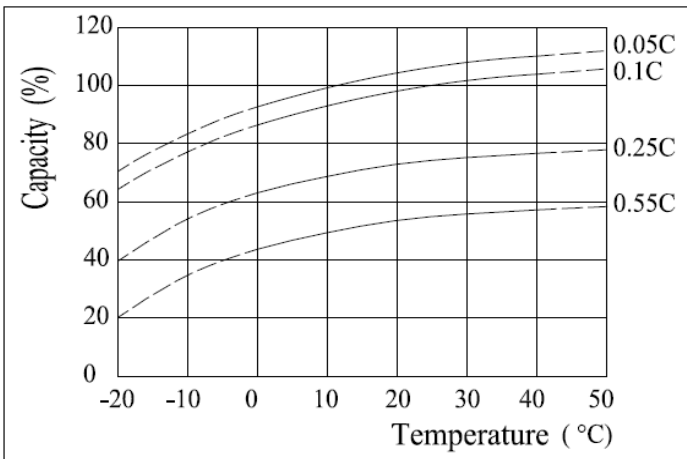

Cycle Life Relation to Depth of Discharge

