

Specifications

Nominal Voltage		12V
Capacity(10hr,25°C)		7AH
Dimension	Length	149±2mm(5.87inch)
	Width	60±2mm(2.37inch)
	Height	130±2mm(5.13inch)
	Total Height	130±2mm(5.13inch)
Approx Weight		Approx. 2.2kg(+ -4%)
Terminal Type		L4
Container Material		ABS(UL-94HB)
Nominal Operating Temp. Range		-20°C~50°C(-4°F~122°F)
Standard Charging method (25°C)	Current	0.7A
	Time	5~10H
Quickly Charging method (25°C)	Current	3.5A
	Time	1h
Terminal material		Lead

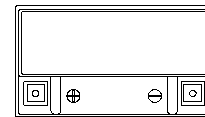

Dimensions

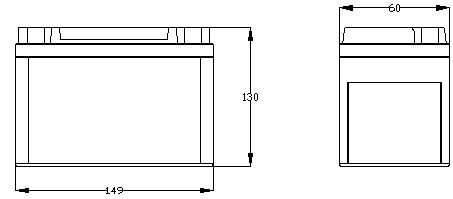

Terminal

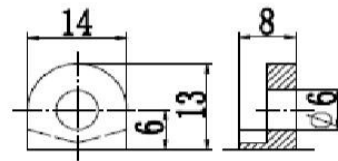

Discharge Characteristics(25°C)

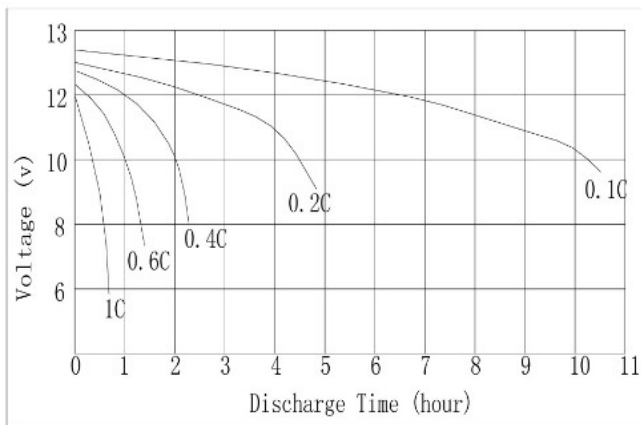

Self Discharge Characteristics

